

INSTALLATION INSTRUCTIONS

Surface Lighting_299Lighting

BELLART SURFACE

BELLART SURFACE

INSTALLATION INSTRUCTIONS

1. ø55 Diameter

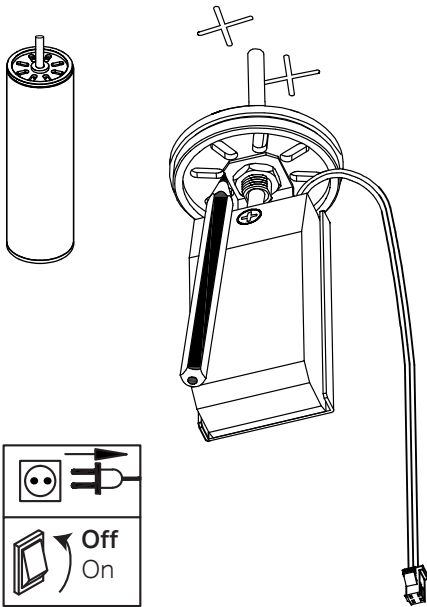

2.

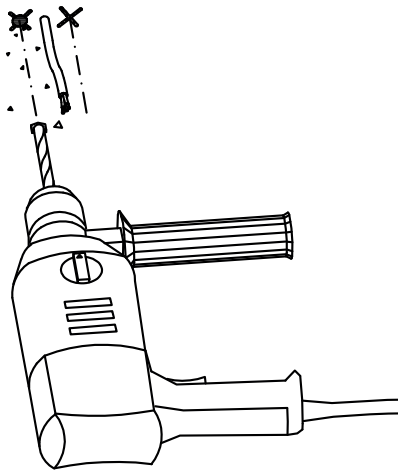

3.

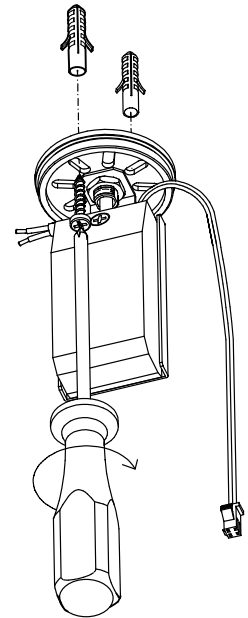

4.

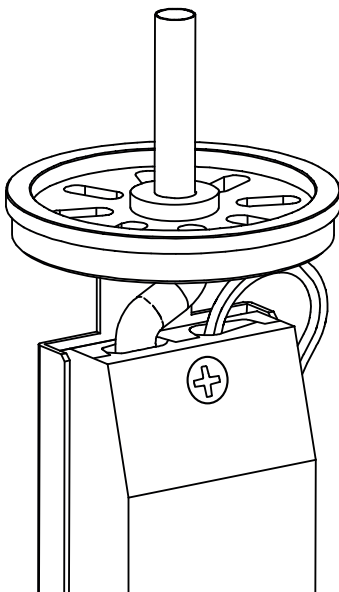

5.

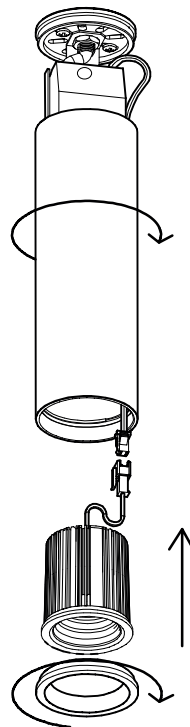

6.

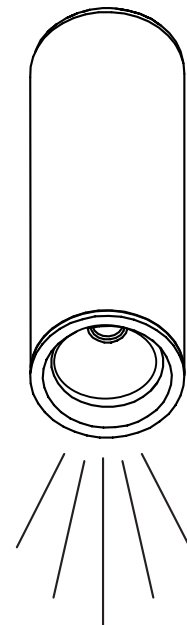

Cover the installation cables with the cable protector and lock the cable of the luminaire with the driver cover.

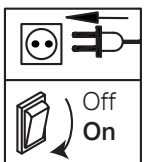

BELLART SURFACE

INSTALLATION INSTRUCTIONS

1. ø90 | ø120 Diameters

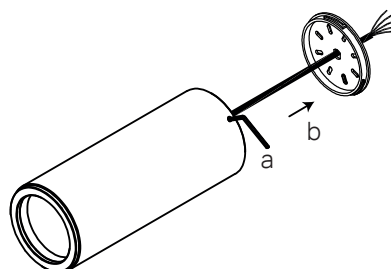
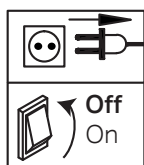
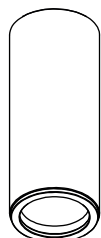

2.a. Concrete

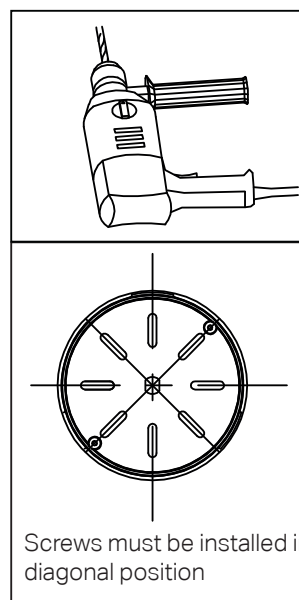
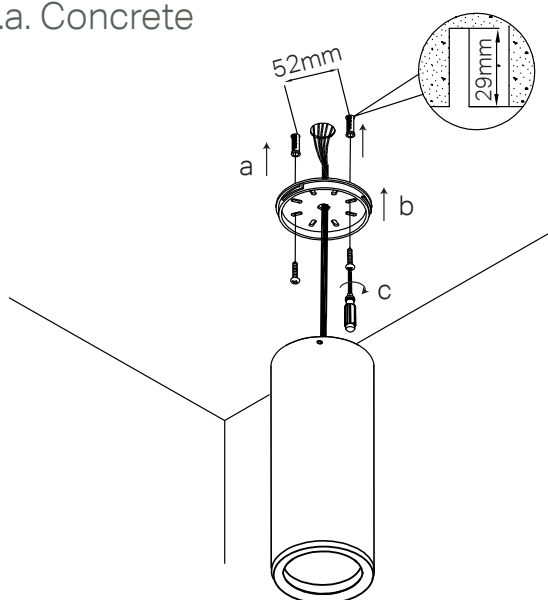

2.b. Wood Roof

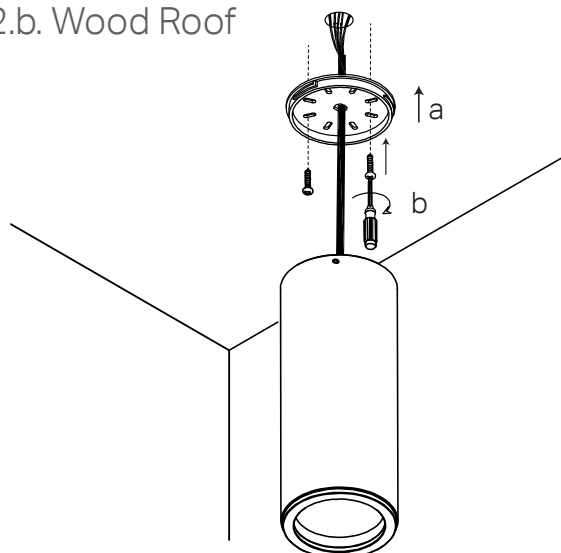

Ensure wood thickness is not less than 5mm!

BELLART SURFACE

INSTALLATION INSTRUCTIONS

3.

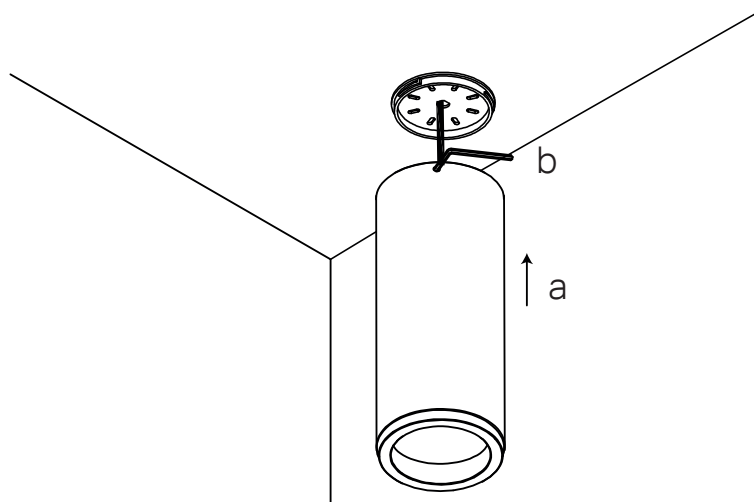

4.

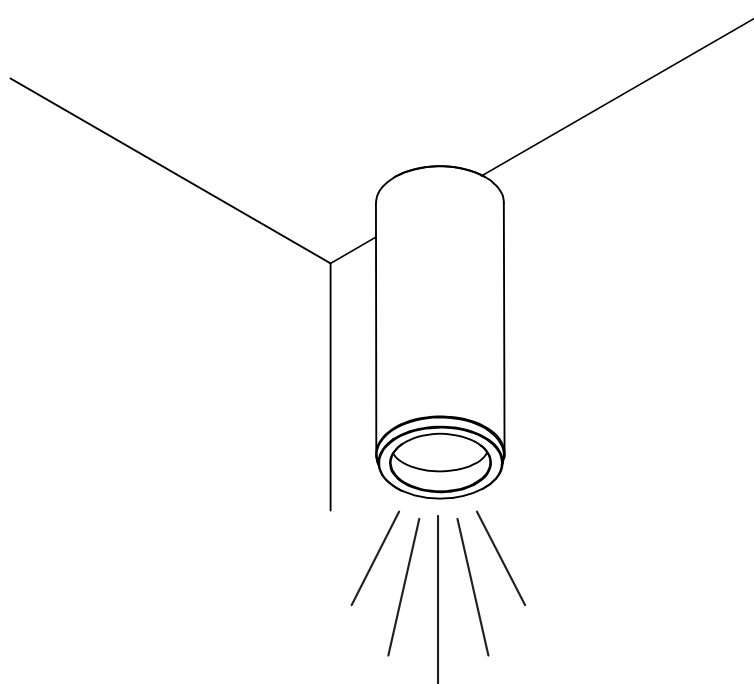

Safety Notes

The safety of this luminaire is guaranteed only if you comply with these instructions; remember to conserve in a safe place
Ensure adequate voltage and frequency is supplied to the equipment
Disconnect from the main power before performing or any maintenance
The installation should be carried out by qualified personnel
For indoor use only

